



# ACCU-CHEK® *Performa*



# Accu-Chek Performa Meter Features

- 5-second test time
- 0.6 – 33.3 mmol (fixed)
- Large display
- 500-value memory
- Back up battery for time and date retention
- IR data port
- Rubber grips
- Operating range 6-32 °C



# Parts of the Meter



## Uses Accu-Chek Inform 2 Strip - Features

- 0.6  $\mu$ L sample size
- 0.10-0.65 Hct range
- Acceptable specimen types:
  - Capillary, arterial, venous, neonate
  - heparin, EDTA tubes - stable 30 min
- Wipe 1<sup>st</sup> drop and use 2<sup>nd</sup> drop
- Easy-fill tip (front edge)
- 2 minutes to apply sample
- 6 gold contacts
- Flip-top container
- Store at room temp.
- No need to write open date on vial. Strips good till expiry date on vial, open or un-opened.



# Meter Display

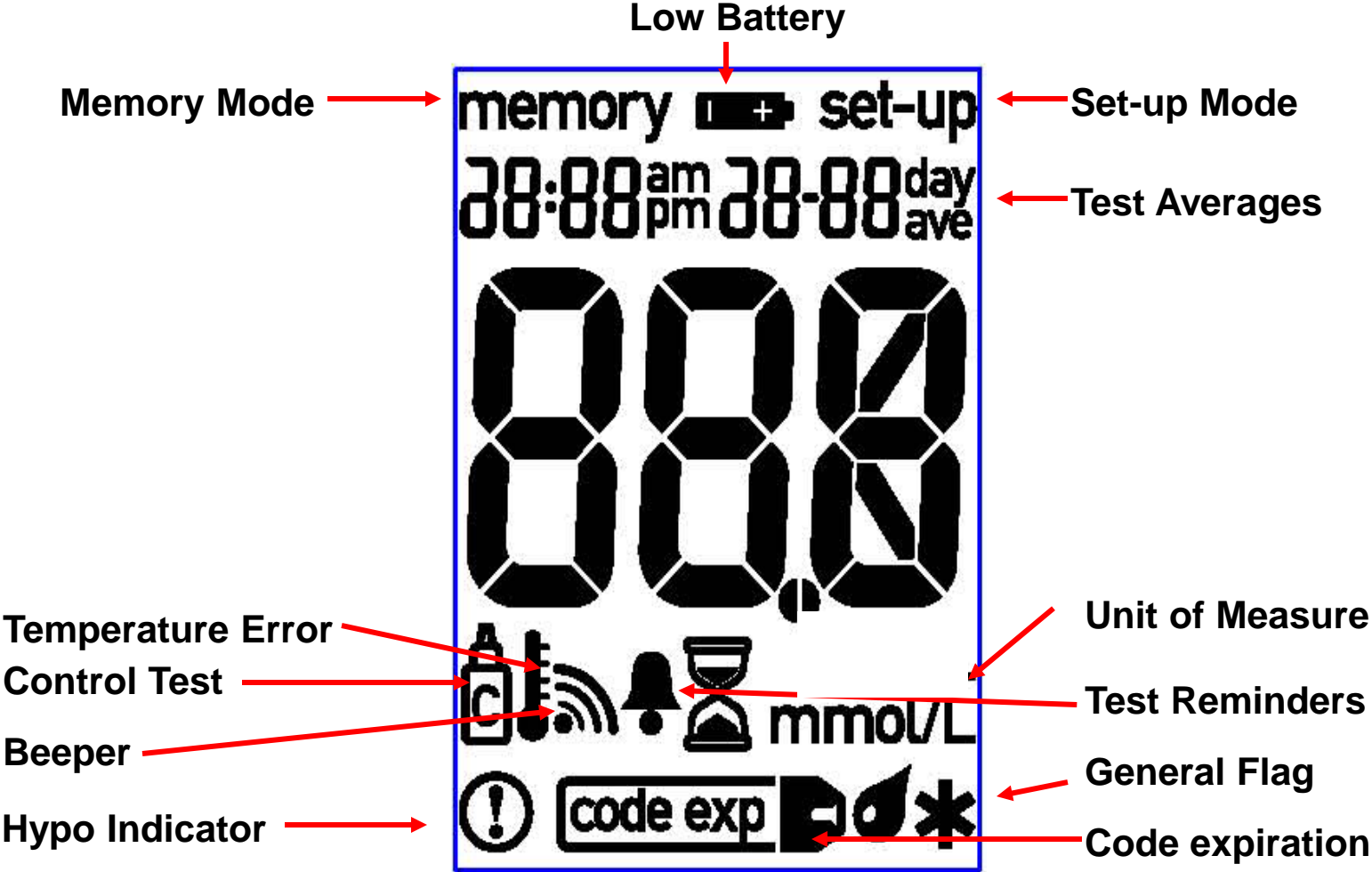

# Performing a Control Test

1. Insert a test strip into the meter.
  - Make sure the **code number** displayed **matches** code number on test strip container
2. Place the meter on a flat surface.
3. Mix **QC solution** by gently inverting bottle 5 times. Remove cap and wipe the bottle tip with a tissue to remove any dried residue.
4. Squeeze the bottle and wipe away the 1<sup>st</sup> drop into tissue.
5. Touch the 2<sup>nd</sup> drop to the front edge of the yellow window.
6. Hourglass will appear (if enough sample applied)

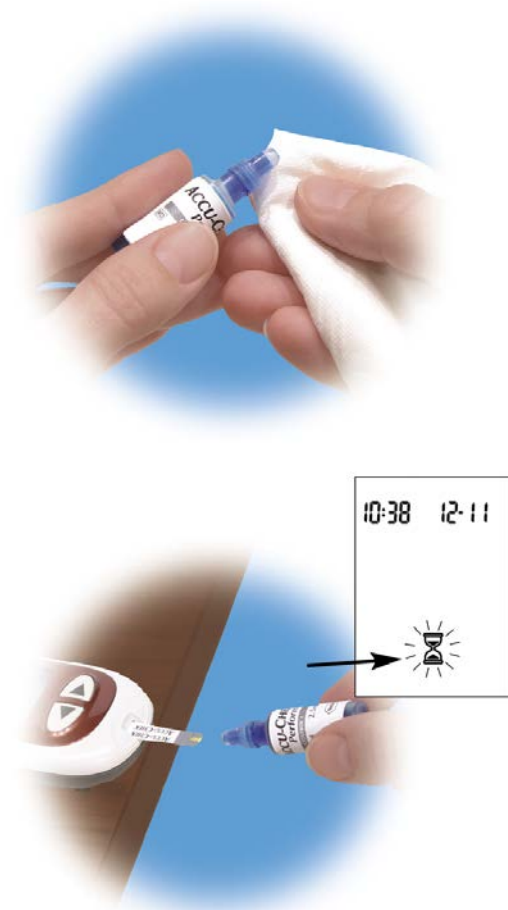

# Performing a Control Test Cont'd

7. The screen will display:
  - A result
  - The control bottle symbol
  - A flashing “L” (for level)
8. Do not remove the test strip.
  - Press an arrow button once to ID as Level 1 control. (For level 2 control, press an arrow button twice in a row)
  - Press the on/off/set button to set the level in the meter.

9. **Result is in range** if “OK” and the result alternate in the display (**Control ranges are also listed on test strip vials**)

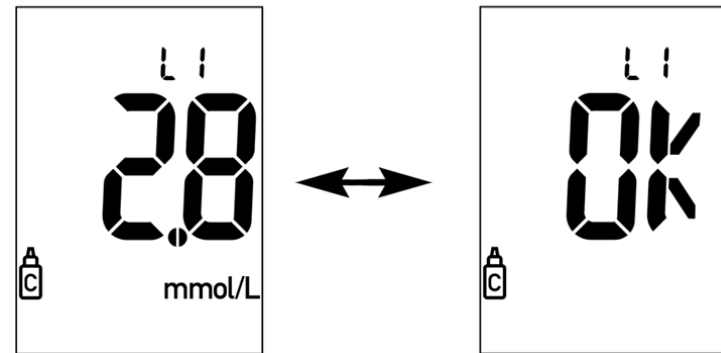

10. Record QC results as per current protocol.

**Quality Control Material is good for 90 days after opening.**  
**Always check the bottle for the open bottle expiry – If opening new bottle, write open date on bottle.**

# If Quality Control is Out of Range

- Did you use control solutions or test strips that were past their expiry date?
  - Control solutions are good for **90 days from opening**
- Did the lot # on the monitor match the lot # of test strips used?
- Did you use the right control solution for the test strips?
- Was the test strip wet, bent, scratched or damaged?
  - If so repeat test with new test strip.

If the above questions are checked, the controls are repeated and are still out of acceptable range, it is the operator's responsibility to report this to Manager for possible replacement of meter.

Run controls on a spare meter immediately **and clean the meter** before any patient testing is performed.



# Performing a Blood Glucose Test

1. Insert a test strip, the meter turns on.
2. Make sure the **code number** on the display **matches the number** on the test strip container. **This is critical at lot change once a year!** If it does not match, remove new chip from box of strips and replace in meter.
3. A test strip and flashing blood drop appear on the display.

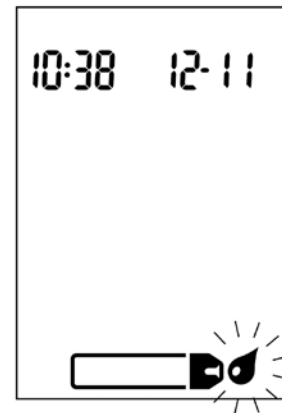

# Performing a Blood Glucose Test

- Clean finger with antiseptic (alcohol, betadine) and allow to completely air dry.
- Perform a finger-stick using your lancet device.
  - Lancets are single-use
  - Discard in sharps after use
- Wipe the first drop away and touch the second drop of blood to the **front edge** of the yellow window. The hourglass will flash.
- Your result appears in 5 secs

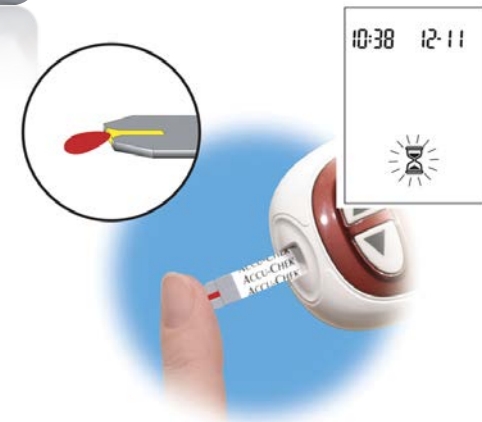

# Performa Meter



## Ranges

Age	Normal Range (mmol/L)	Critical Limits (mmol/L)	Reportable Range (mmol/L)
0 days - 16 years	3.3 - 11.0	less than 2.6 greater than 11.0	less than 0.6 greater than 33.3
17 years - Adult	4.0 - 11.0	less than 2.5 greater than 25.0	less than 0.6 greater than 33.3

# Viewing the Memory

1. From meter On or Off position, press and release the Left arrow button. The most recent result will appear. (if many results in memory, hold down left arrow button to scroll faster)
2. 500 results in memory, will drop oldest after that.

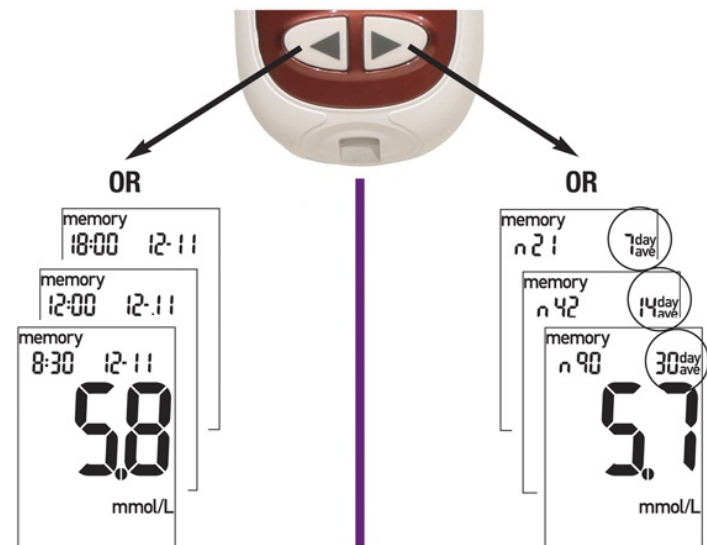

# Inform II Test Strip Interference Levels

(test strip used in Performa and Inform II hospital meter)

- Ascorbic Acid > 0.17 mmol/L (only intravenous)
- Galactose > 0.83 mmol/L (very rare – 1 in 100,000 births)
- Triglycerides > 20.3 mmol/L

# ORDERING INFORMATION

	<p align="center"><b>RESIDENTIAL CARE and NON-ACUTE AREAS</b></p>	
<div style="text-align: center;">  <p>Not for use in Acute areas</p> </div>	<p><b>PERFORMA METER (USED in NON-ACUTE AREAS ONLY)</b></p> <p>Cat#04861574164</p> <hr/> <p><b>PERFORMA METER REPLACEMENT BATTERY</b> available from any vendor who supplies batteries</p>	
		<p><b>NH item # 5290012</b></p> <p><b>ACCU-CHEK TEST STRIPS</b> EACH VIAL/50 STRIPS</p> <p>(USED on BOTH ACCU-CHEK AND PERFORMA METERS)</p>
		<p><b>NH item # 5290063</b></p> <p><b>ACCU-CHEK CONTROLS</b></p> <p>USED on BOTH ACCU-CHEK AND PERFORMA METERS</p> <p>1 BOX = 1 bottle of CONTROL 1 and 2</p>

# Quick Guide

## Performing a Patient Test

1. Insert a test strip into the meter in the direction of the arrows. The meter turns on.
2. Make sure the code number displayed on the meter matches code number on test strip container. A test strip and flashing blood drop will appear on the display.
3. Clean finger and ensure completely dry. Perform a finger-stick using your lancet device.
4. Wipe the first drop away and touch the second drop of blood to the front edge of the yellow window of the test strip.  
When an hourglass flashes on the meter display screen, sufficient blood sample has been applied to the test strip.
5. Result appears on display in 5 seconds. The meter turns itself off 5 seconds after the test strip is removed.
6. Document result *immediately* – there is no identity associated to the results.

## Cleaning the Meter

1. Be sure meter is off.
2. VIHA approved cleaning/ disinfecting product is Percept
3. Squeeze out excess moisture from the wipe before use.
4. Place meter on a level surface and gently wipe the meter surface with Percept wipe.
5. Ensure no moisture enters the code chip or test strip slots.
6. Meter must remain wet for the designated contact time. (5 mins for Percept)
7. Discard wipe. (Repeat steps with another wipe to disinfect meter).
8. Ensure meter is thoroughly DRY
9. Never immerse the meter in water.



## Performing a Quality Control (QC) Test

1. Insert a test strip into the meter in the direction of the arrows. The meter turns on.
2. Make sure the code number displayed on the meter matches code number on test strip container.
3. Put the meter on a flat surface. Select the control solution to be tested. The level is entered later.
4. Mix control solutions by gently inverting bottle 5 times. Take cap off and wipe tip of the bottle with a tissue to remove any dried residue.
5. Squeeze the bottle, wipe away the 1st drop and then touch the 2nd drop to the front edge of the yellow window.  
When you see an hourglass appear on the meter display screen, you have enough control solution in the test strip.
6. The result appears on the display in about 5 seconds, along with the control bottle symbol and flashing "L." Do not remove the test strip.
7. Press arrow button once to ID as Level 1 control. (For level 2 control, press arrow button twice).
8. Press the on/off/set button to set the level in the meter.
9. Result is in range if "OK" and the result alternate in the display (Control ranges are also listed on test strip vials).

**Common Error Messages:** (In most scenarios, meter screen will display error and how to resolve.)

Display	Likely Cause	Action	Display	Likely Cause	Action
code exp	Test strips expire end of current month	Insert new code chip by month end	E – 5	Test strip has expired	Ensure time/date setting is correct Ensure code chip # matches vial #
---	Code chip not inserted	Turn off meter and insert code chip	E – 6	Blood or control was applied too early	Discard strip and repeat test
E – 1	Test strip is damaged	Replace strip with new one	E – 7	Electronic error	Turn meter off and on, or remove/reinsert battery
E – 2	Incorrect code chip	Turn off meter and insert new chip	E – 8	Temp is above/below proper range	(6-44°C) Move to area in proper range and repeat in 5 mins
E – 3	Test error	Discard strip and repeat test	E – 9	Battery is running low on power	Change battery
E – 4	Insufficient blood (control) after test star	Discard strip and repeat test	E – 10	Time/date settings may be incorrect	Check time/date settings and correct if needed

# Service Information



## When the meter does not work:

1. Phone Roche Care Center Help Line @ 1-877-273-3433
2. Tell them what the problem is and they will try to troubleshoot the problem over the phone. If they can't resolve the problem, they will replace the meter for free once they receive a PO.
3. Create a PO by ordering a new meter in e-Rex on a manual PO or on a paper manual requisition. Order Cat # 04861574164.
4. Once you receive the new meter, send the damaged meter to Roche.



# Certification:

## Get certified to use the Meter

1. Review the Accu-Chek Performa Meter PowerPoint
2. Complete the Accu-Check Performa Meter Quiz and check your own answers using the answer key at the bottom of the page.
3. Demonstrate skill to your Manager or Facility Resource using the Competency Checklist for hands on support and certification sign off.

## Maintaining Competency: Experienced Meter Users

1. Maintain your competency by using the meter & reviewing the Accu-Chek Performa Meter PowerPoint at least annually.
2. Use the **Quick Reference Guide**.
3. Get support from your Manager or Facility Resource.

## Maintaining Competency: Manger or Unit Resource

1. Maintain your competency by using the meter & reviewing the Accu-Chek Performa Meter PowerPoint at least annually.
2. Watch first time users demonstrate skills listed in the [Competency Checklist Form](#) & sign the form.
3. Provide support to experienced users.